

Addonics
TECHNOLOGIES

User Guide



Sapphire eSATA/USB 3.0 Drive Enclosure (SESCS, SESU3CS)

www.addonics.com

Technical Support

If you need any assistance to get your unit functioning properly, please have your product information ready and contact Addonics Technical Support at:

Hours: 8:30 am - 6:00 pm PST

Phone: 408-453-6212

Email: <http://www.addonics.com/support/query/>

Unpacking and Overview

Front View



SESCS, SESU3CS

Back View

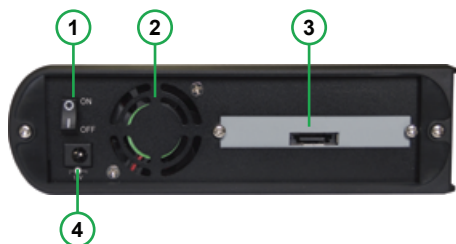

1. On/Off Switch
2. Cooling Fan
3. eSATA Port
4. Power Connector

Inside View

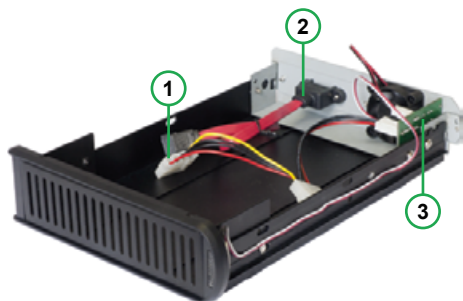

1. 4P Molex Power Connector
2. SATA-eSATA Bridge
3. Power Board



eSATA cable



eSATA to USB 3.0 Adapter (Model SESU3CS)



Power Cable

Installation

1. Loosen the two cover screws on the back of the unit found on the left and right edges. Remove the rear cover, then slide the top cover off.
2. Remove the front plate and replace with a 5.25" drive, or a 2.5" or 3.5" device mounted in a 5.25" mounting bracket using the 5.25" drive mounting holes.
3. Reassemble the unit.
4. Connect the power supply from an AC outlet to the back of the unit.
5. Connect an eSATA host to the unit and turn it on. For Model AESU3CS, optionally attach the eSATA-USB 3.0 Adapter to connect the unit to USB host.

CONTACT US

www.addonics.com

Phone: 408-573-8580

Fax: 408-573-8588

Email: <http://www.addonics.com/sales/query/>