

MFR™

Multi Function Recorder



QUICK START GUIDE

Addonics®

ENG

PACKAGE CONTENTS



* If there are any shortages, please contact your local dealer.

CHARGING BATTERY SET

1. Connect the battery set with the MFR.
2. Connect the power adapter from the MFR to the wall outlet(100-240V) to recharge the battery set.



3. The LED on the battery set will light until the charging finishes.



4. While charging, the MFR still can be used as usual.

* The MFR also can work only with connected power adapter instead of the battery set.

REMOVING BATTERY SET

1. Turn the MFR over.
2. You can see the ejector of the battery set. Push the ejector to the right and pull the battery set to take it off.



SET BATTERIES OF REMOTE CONTROLLER

1. Remove the battery cap on the rear face of the remote controller.
2. Insert the 2 AAA batteries into the battery slot.
3. Recover the battery cap.



POWER ON/OFF MFR

1. You can power on/off the MFR by the power switch.
2. When the power switch is on, you can use the remote controller to turn MFR off and on again.

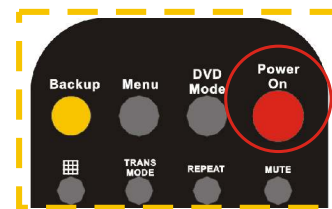

BACKUP DATA FROM STORAGE CARD TO CD-R/CD-RW

1. Power on the MFR.
2. Press the ejector on the front panel to eject the CD tray. Insert a piece of CD-R/CD-RW into the tray and then push the tray back to close it.



After the CD tray is shut, the system will load the disc automatically. You can read the info from the LCD .



3. After the disc loading process(for about 10 seconds), insert the storage card you want to backup.

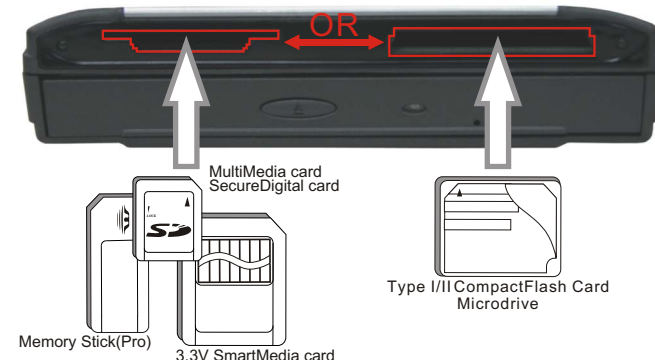

* The MFR allows backing up one card at one time, so please do not insert two cards simultaneously.

4. Press the backup key once to get ready to backup. Press the backup key once again to proceed and begin backup; or press the stop key to cancel the process.

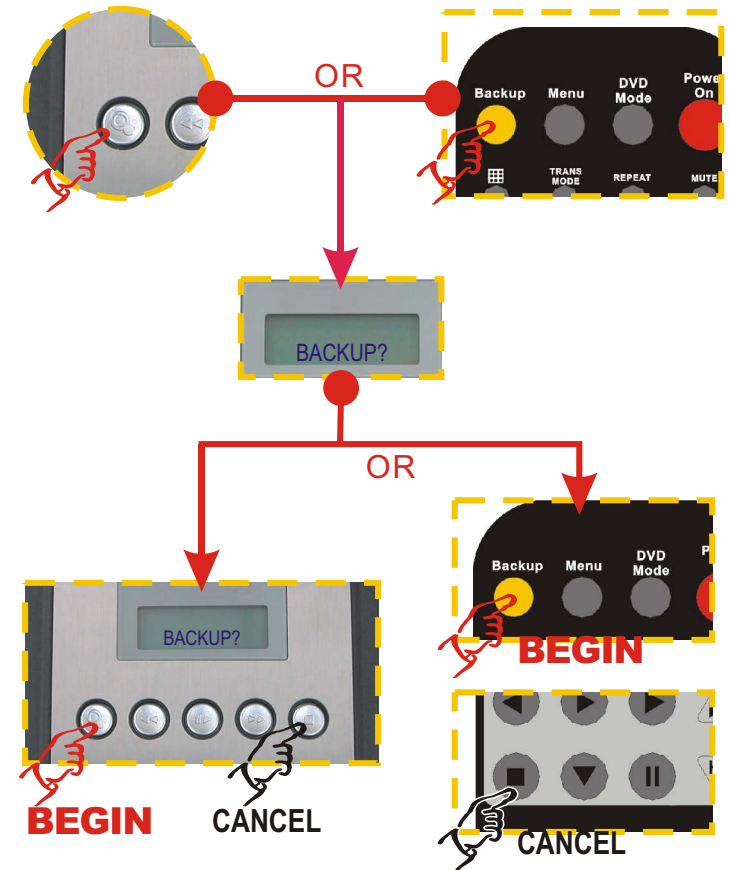

5. After the burning begins, you can read the burning process on the LCD.



6. The burning process is done, and the CD tray will extract the CD-R/CD-RW automatically. Backup completes.



* The MFR supports multi-session burning. If there is still free space in the burned CD-R/CD-RW, you can use it for backup again.

CONNECT MFR TO TV SET OR PROJECTOR

1. Connect the RCA cable from the video and audio output of the MFR to the video and audio input of the TV/projector.

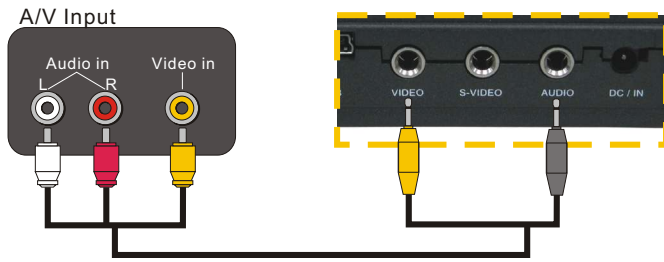

2. If your TV/projector is equipped with S-video input, you can connect the RCA cable from the audio output of the MFR to the audio input of the TV set/projector; and the S-video cable from the S-video output of the MFR to the S-video input of the TV/projector.

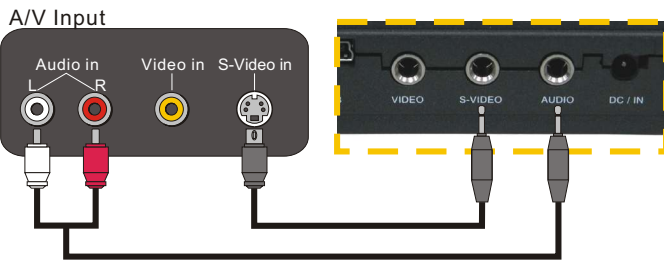

* About the accurate position of A/V input, please refer to the manual of your TV set or projector.

PLAY MOVIE DVD

1. Connect the MFR to TV/projector.

2. Turn the MFR on.



3. Extract the CD tray and insert the movie DVD.



4. The MFR will load the DVD automatically.



5. After the DVD loading process (about 5 seconds), the MFR will begin to play the DVD automatically.



6. While playing, you can use the control panel or the remote controller to stop/pause/forward/backward the movie just like any other DVD players.

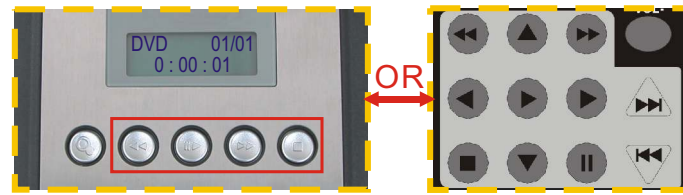

PLAY JPEG/MPEG/MP3 FILES IN STORAGE CARD

1. Connect the MFR to TV/projector and power it on.
2. Insert the card contains files you would like to play.

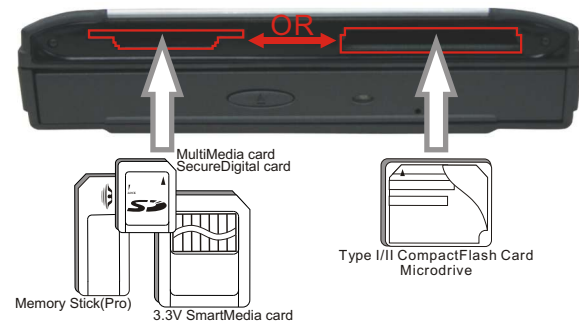

* **The MFR allows playing one card at one time, so please do not insert two cards simultaneously.**

3. After the insertion of the card, the MFR will transfer to storage card media player "Smart Navi" mode.

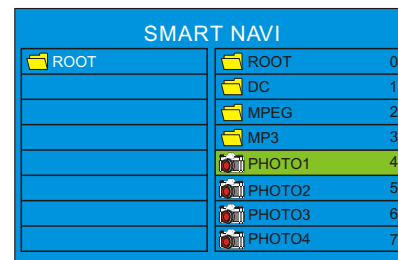

4. Use the **arrow key** on the remote controller to move the green light bar.

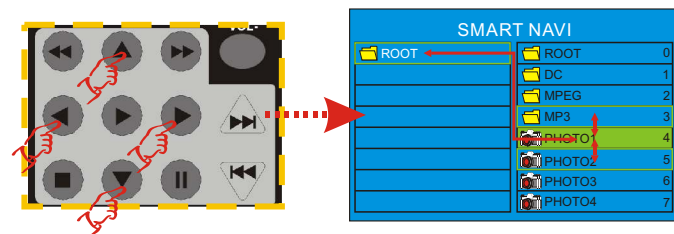

5. Moving the light bar on the folder you want to enter or the file you want to play, and then press the **play key** to enter the folder or play the file.

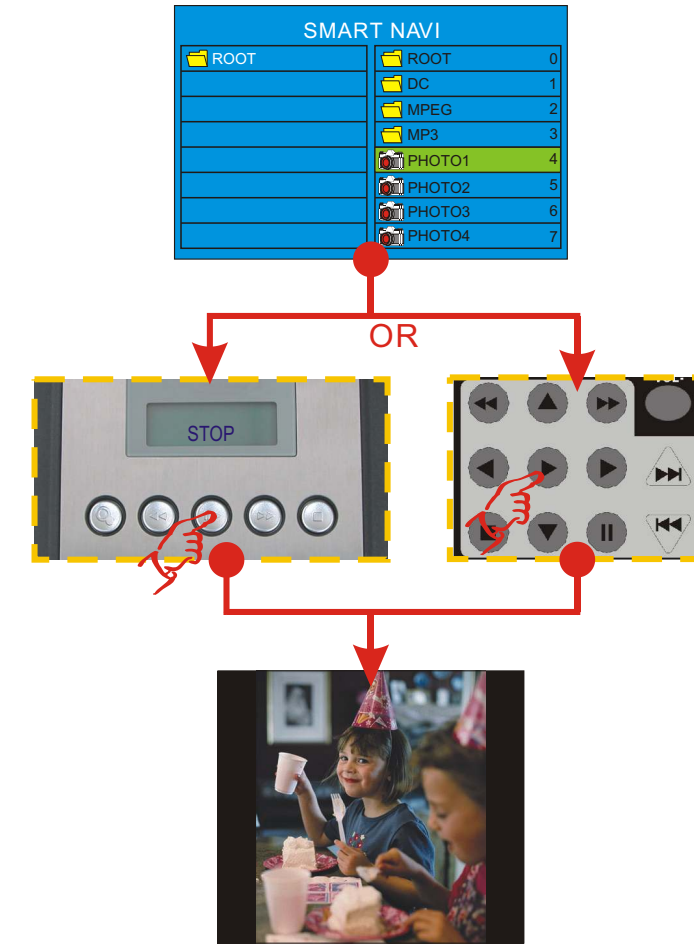

* While playing DVD movie, insertion of storage card will make the MFR stop playing DVD and automatically transfer to "Smart Navi" mode. To return to DVD playing, press **DVD Mode** key on the remote controller; and to go to Smart Navi mode once again, just re-insert the card.

CONNECT MFR TO PC/MAC

1. Power on your PC/Mac, and enter Windows ME/2000 SP3/XP or Mac OS 10.1.3 above.

* **The MFR is currently generic driver supported by Windows ME/2000 SP3/XP and Mac OS 10.1.3 above. For Windows 98/98SE, additional device driver setup is required. MFR does not support any OS which is not mentioned above.**

2. Power the MFR on.

3. Connect the USB cable from the MFR to the USB/Hi-Speed USB port of the computer.

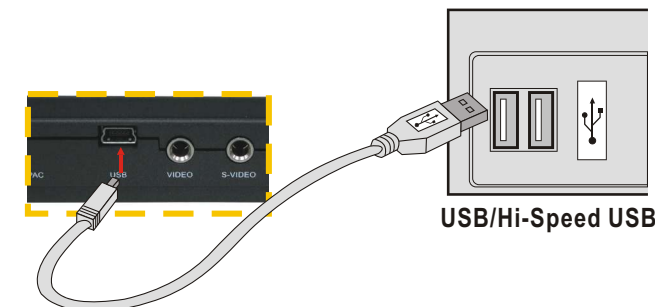

4. After the connection, the OS will automatically detect and register new devices.

In **Windows ME/2000 SP3**, there will be two disk icons added into **My Computer**.



DVD-ROM/CD-RW

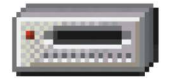

Storage Card Reader

In **Windows XP**, there will be two disk icons added into **My Computer**.



DVD-ROM/CD-RW



Storage Card Reader

In **Mac OS 10.1.3** above, insert a storage card or a DVD/CD to make the icon present on **desktop**.



DVD/CD



Storage Card

READ/WRITE STORAGE CARD ON PC/MAC

1. Insert the storage card you want to read/write.

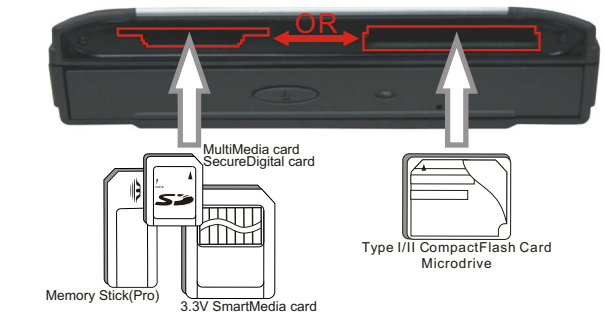

* **The MFR allows reading/writing one card at one time, so please do not insert two cards simultaneously.**

2. Double-click the removable disk in My Computer on Windows; or the new disk icon presents on desktop on Mac. Then you can read/write the storage card as the way you use any other disks on PC/Mac.

READ DVD/CD OR WRITE CD-R/CD-RW ON PC/MAC

1. Insert the DVD/CD you want to read.
2. You can read the DVD/CD as the way you use any other DVD-ROM/CD-ROM.
3. To write a CD-R/CD-RW, you must have a pre-installed burning software.
4. Insert a CD-R/CD-RW into the MFR and burn the disc as the way you use any other CD-R/CD-RW drives.